

REACH & RoHS  
COMPLIANT

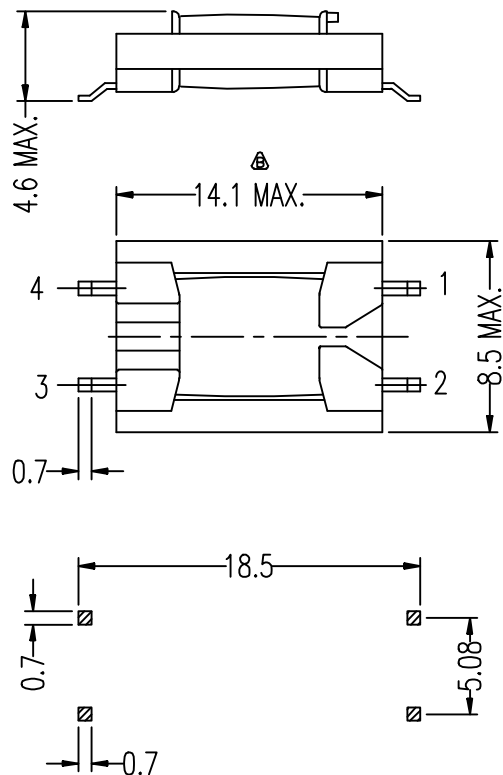
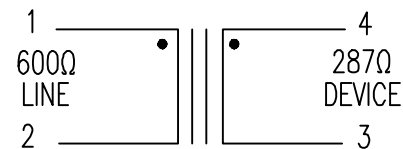
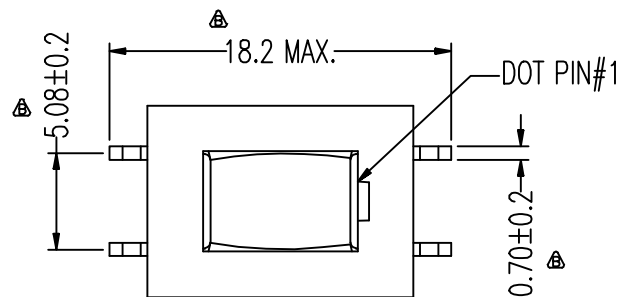

ELECTRICAL CHARACTERISTICS: (FOR V.90, MEET UL1950)

1. DCR : PIN 1-2 = 180Ω MAX. PIN 3-4 = 160Ω MAX.
2. INDUCTANCE (@1KHz, 1Vrms, LP.) : PIN 1-2 = 1.6Hy MIN.
3. INSERTION LOSS (@1KHz, 0dBm, PIN 3-4 W/H 287Ω)  
PIN 1-2 = 3.5 dB MAX.
4. FREQ. RESP.(REF. 1KHz) : @200Hz-5KHz = ± 0.3dB
5. RETURN LOSS (REF. 600Ω) : @300Hz - 3500Hz = 20dB MIN.
6. TURNS RATIO(@15KHz,1Vrms) : PIN 1-2 : PIN4-3 = 1 ± 1%
7. LONGITUDINAL BAL. = 60dB MIN.(@200-4KHz)
8. T.H.D.(@600Hz,-10dBm) = -75dB MAX.
9. HI-POT (@1650VAC, 1mA, 2SEC.) PRI.-SEC.
10. RoHS COMPLIANC.

TITLE:  
Audio Transformer

SIZE  
A4  
UNITS  
MM[INCH]

GENERAL TOLERANCES  
UNLESS SPECIFIED

APPROVED BY:  
Geoffrey.Song

PART NO.:  
WHTT4202

SACLE  
1:1  
REV  
A0

$x \pm 0.35$	$x^\circ \pm 3.0^\circ$
$.x \pm 0.30$	$.x^\circ \pm 2.0^\circ$

CHECKED BY:  
Elvis.Song

REMARK:

SHEET  
1/1



$.xx \pm 0.25$	$.xx^\circ \pm 1.5^\circ$
$.xxx \pm 0.10$	$.xxx^\circ \pm 1.0^\circ$

DESIGND BY:  
Sunny.Xu

**VOOHU** 苏州沃虎电子科技有限公司  
Su Zhou Voohu Electronic Tech.Co.Ltd

TEL: +86 400 1048 018

WEB: [WWW.WOHU-TEK.COM](http://WWW.WOHU-TEK.COM)